

MACK'S LURE

SHUTTLE HAWK™

ATTACHED TO YOUR DOWNRIGGER CABLE, THE DIVER WILL TAKE YOUR RELEASE, LINE AND LURE TO A DESIRED DEPTH UNTIL RELEASED. THEN, THE SHUTTLE HAWK™ RETURNS TO THE SURFACE TO BE SENT DOWN AGAIN, MAKING IT UNNECESSARY TO RAISE OR LOWER YOUR DOWNRIGGER.

ATTACH LINE TO ULTRA RELEASE™



ADJUST TENSION SCREW SO LINE CAN LIGHTLY SNAP IN AND OUT.



MAKE A LOOP WITH YOUR THUMB AND FINGER, THEN ROLL LINE IN BETWEEN THEM, AS SHOWN.



PLACE THE TOP OF THE LOOP IN THE RELEASE SLOT SHOWN ABOVE, THEN PULL BACK UNTIL THE LINE SNAPS IN.

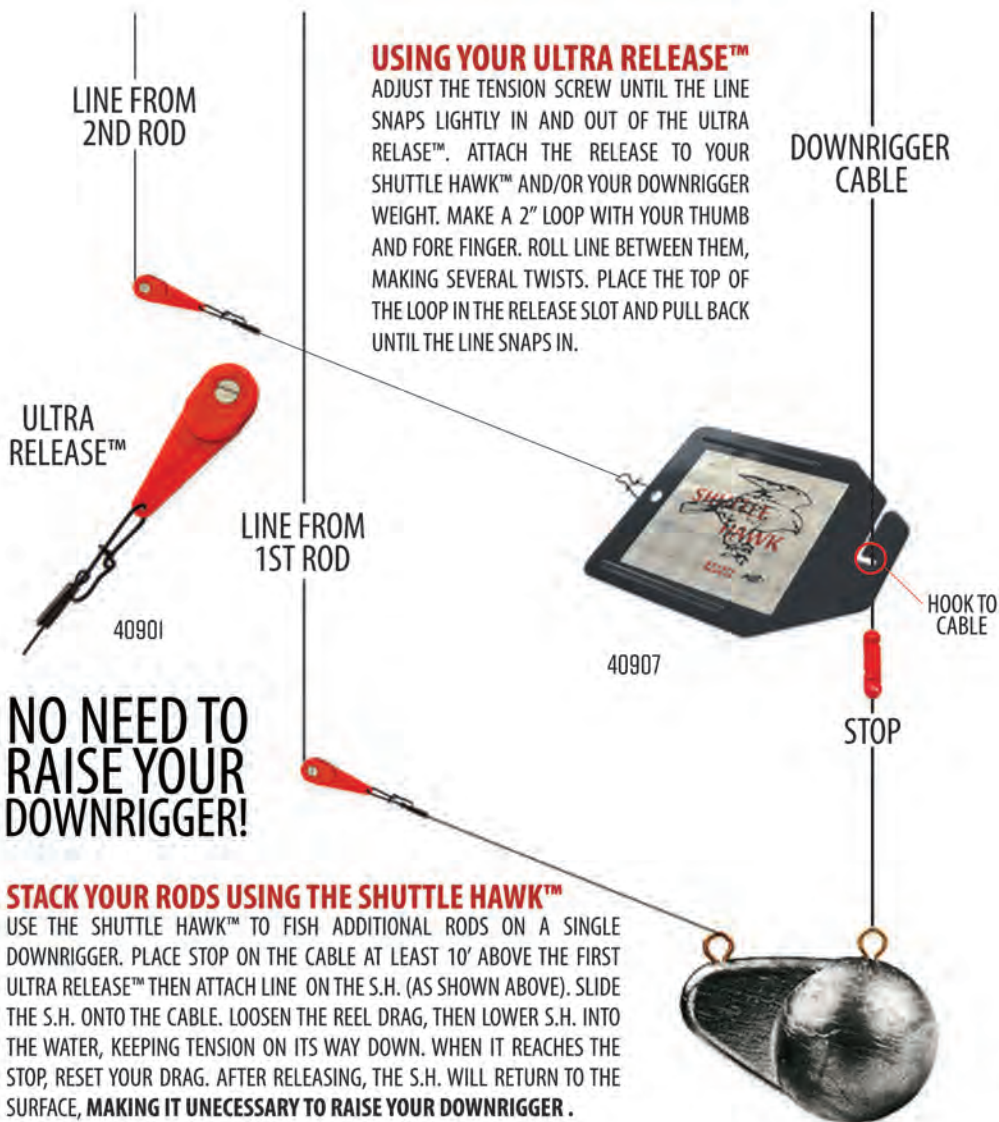

DOWNRIGGER STACKING SYSTEM

SCAN FOR HOW-TO VIDEO



COLOR	SKU	QTY
Shuttle Hawk™	40901	1
Ultra Release™	40907	2

SHUTTLE HAWK™ INCLUDES ULTRA RELEASE™ & STOP

